



LISBOA CICLÁVEL

AVENIDA ALMIRANTE REIS

Pista Ciclável Pop-up



CONCEITO

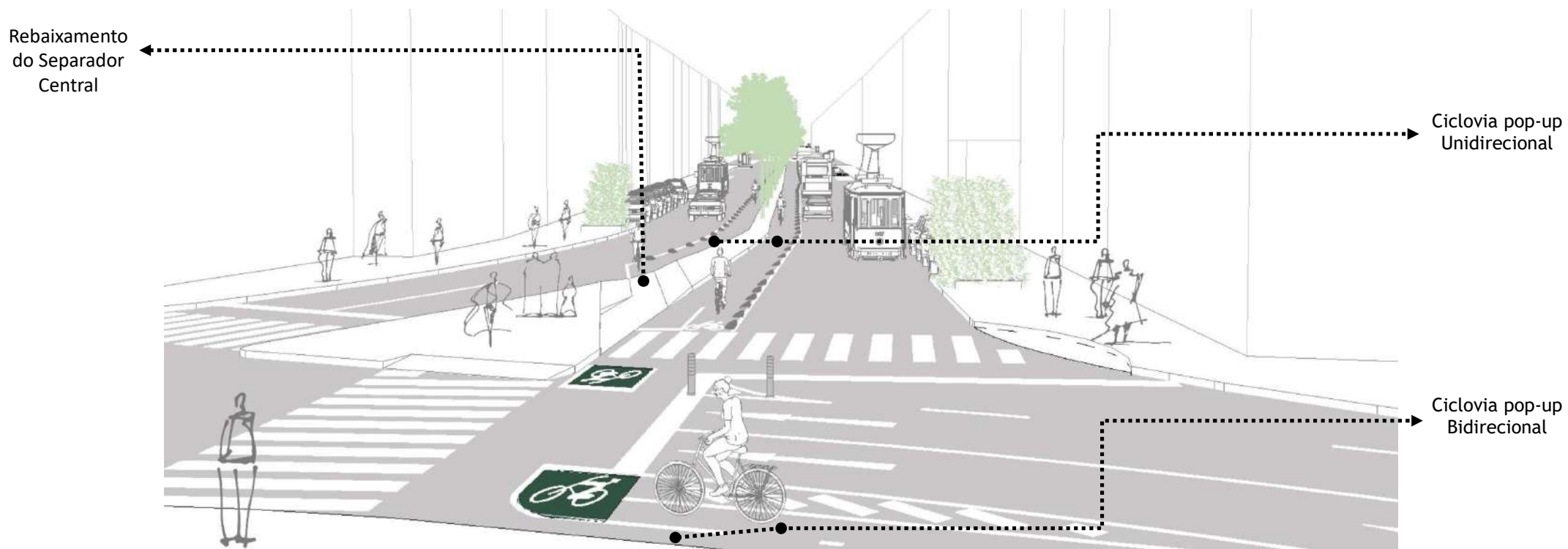

Troço 1

Rua João das Regras - Praça Martim Moniz

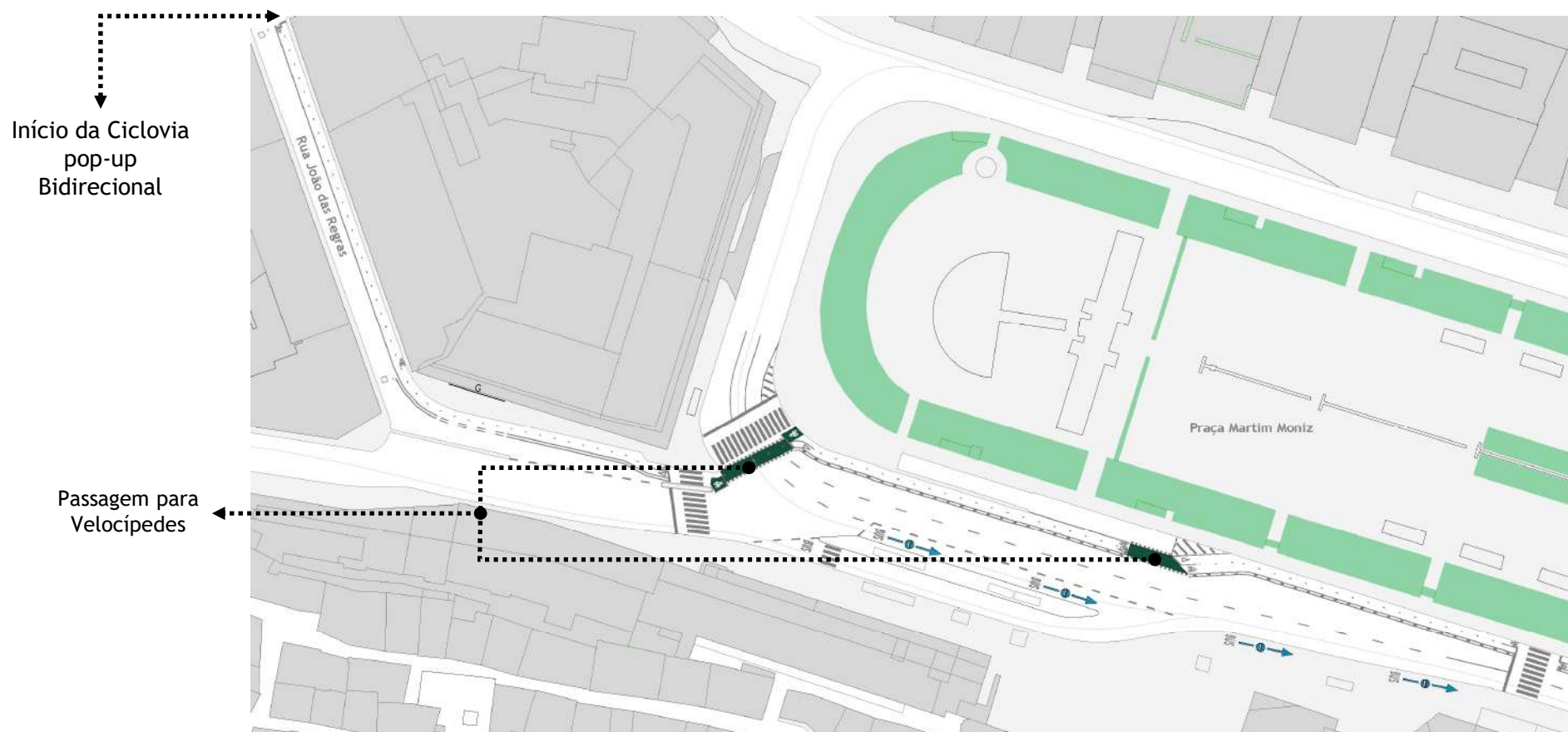

Troço 2

Praça Martim Moniz - Rua da Palma

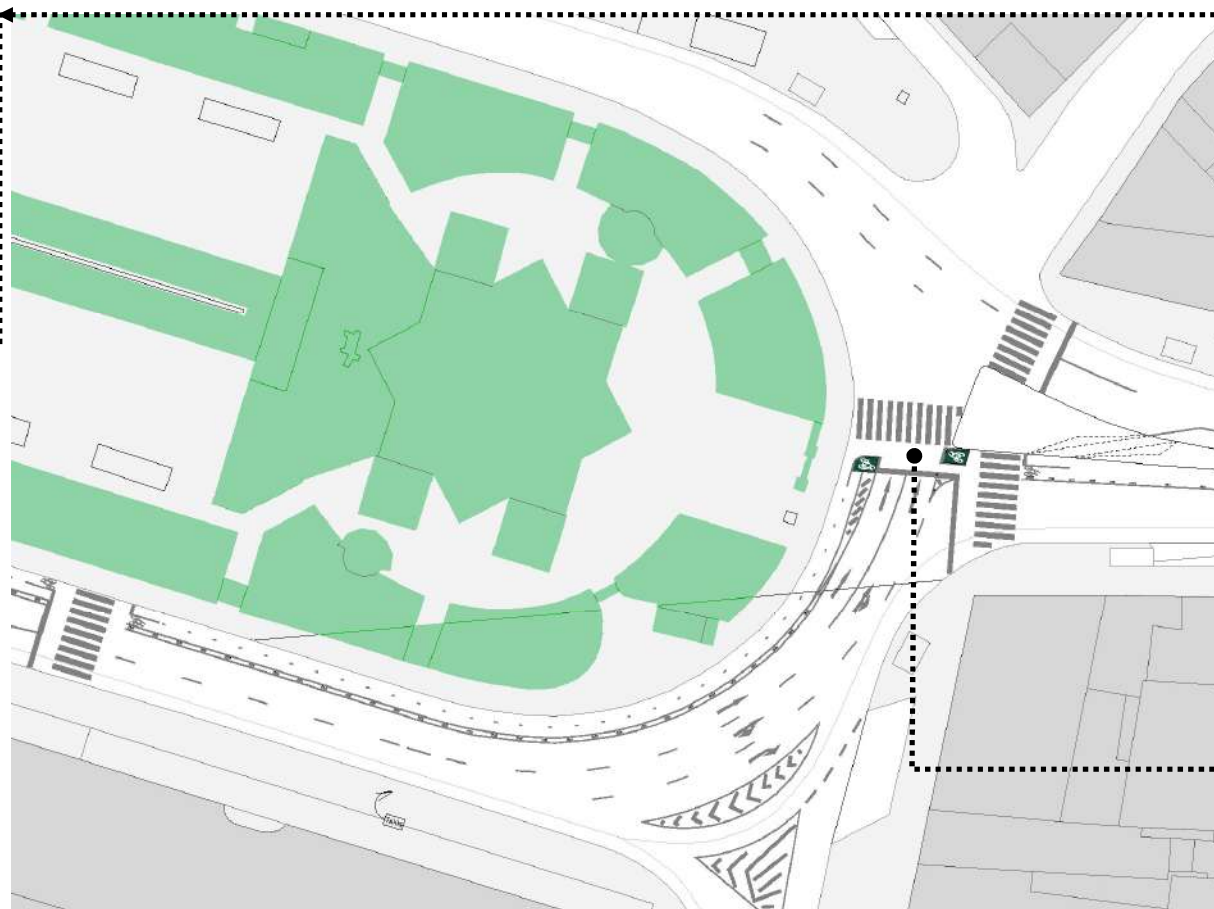
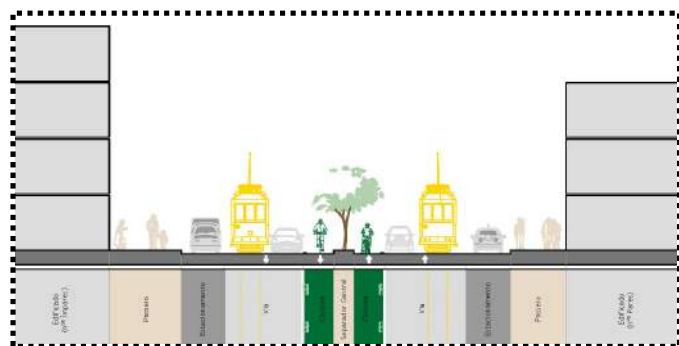

Ligação à Ciclovia
pop-up
Unidirecional

Troço 3

Rua da Palma



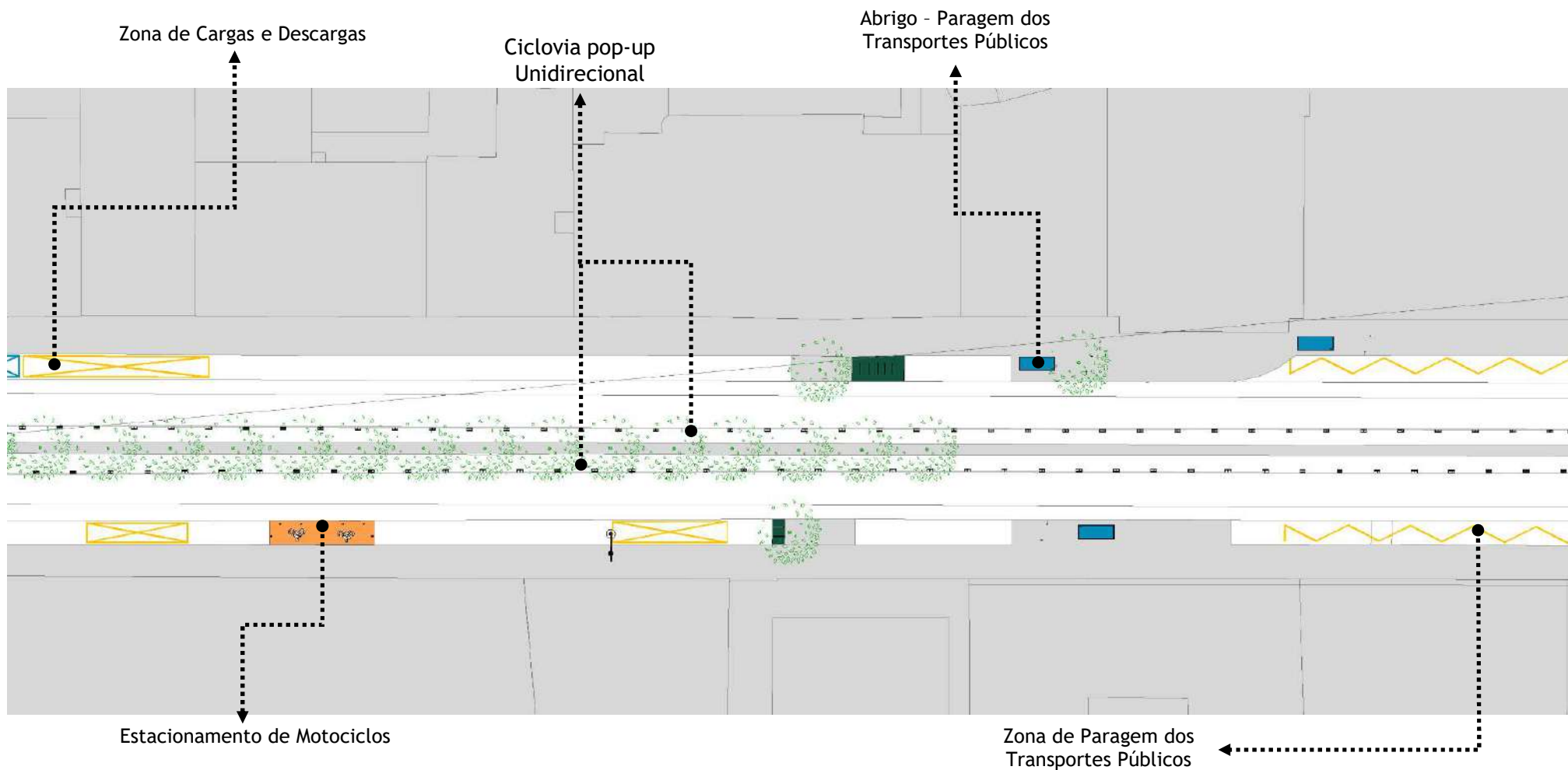

Troço 5

Rua da Palma - Avenida Almirante Reis

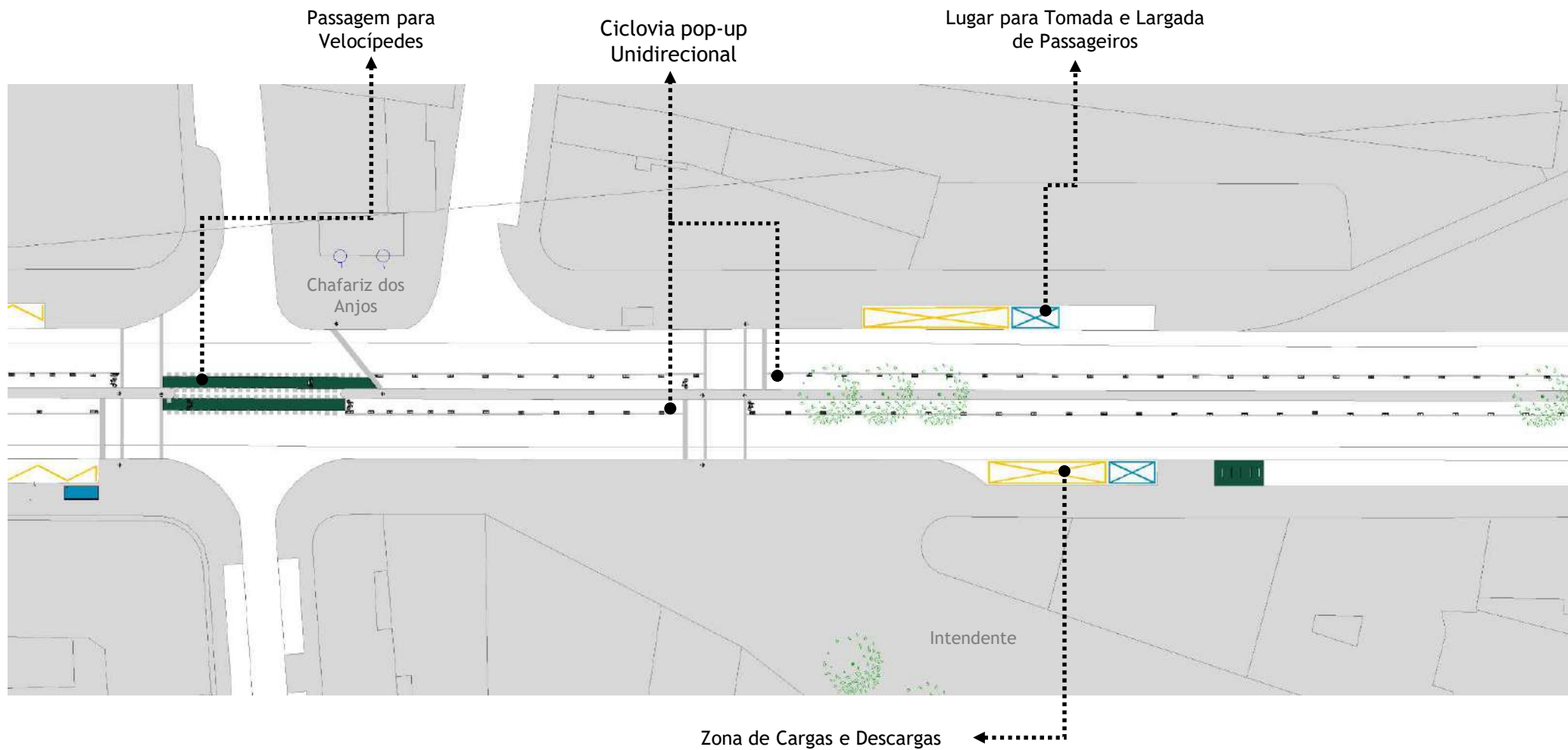

Troço 6

Avenida Almirante Reis

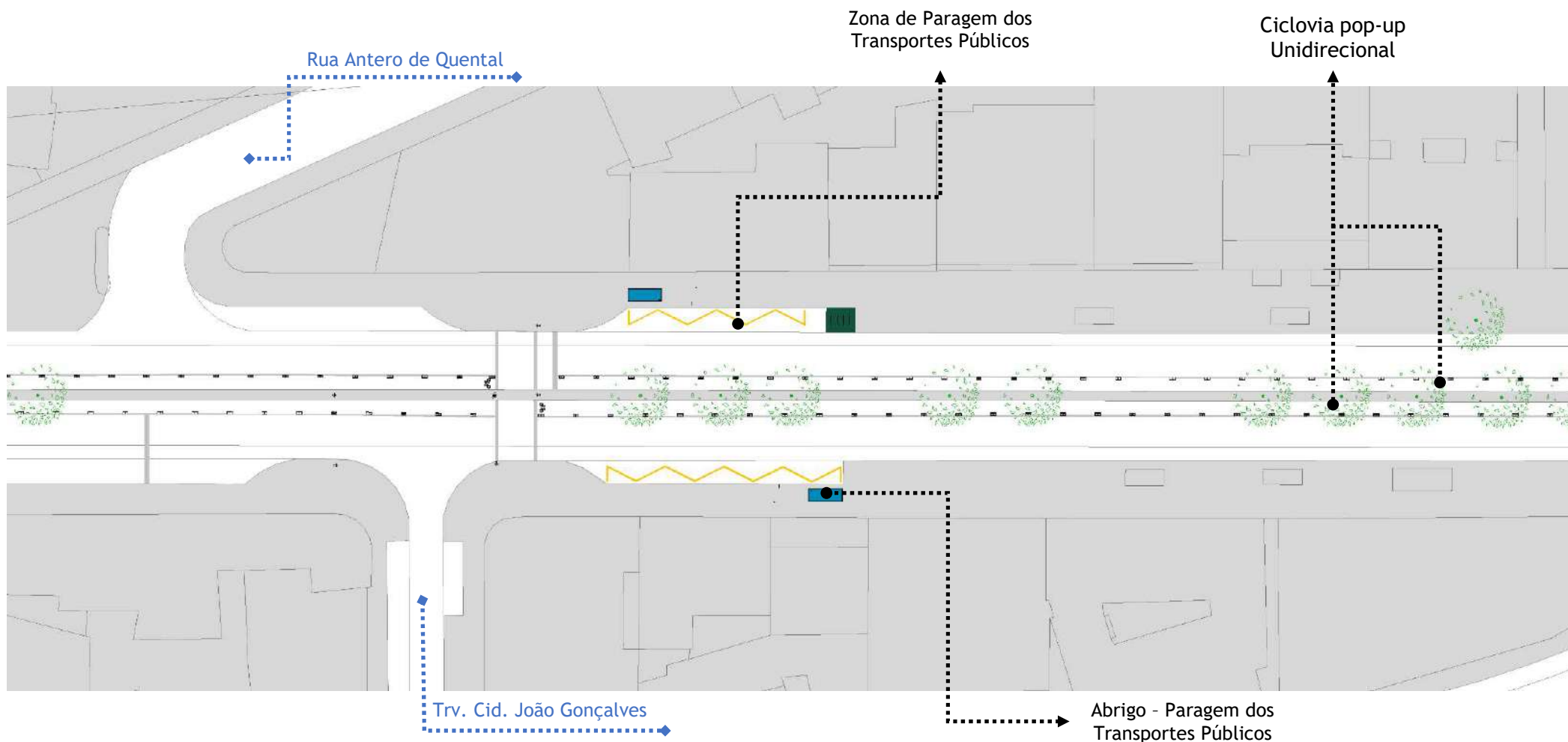

Troço 7

Avenida Almirante Reis

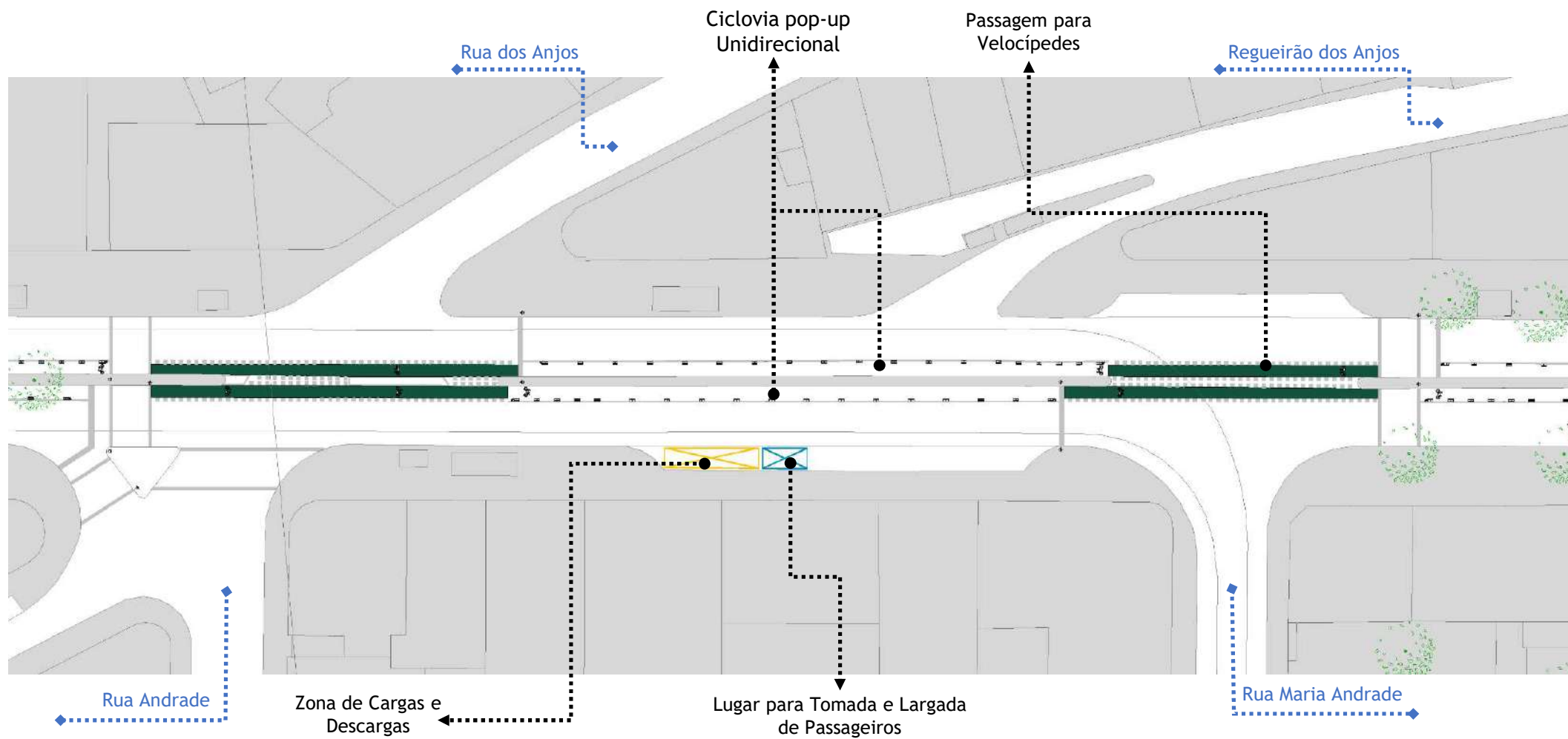

Troço 8

Avenida Almirante Reis

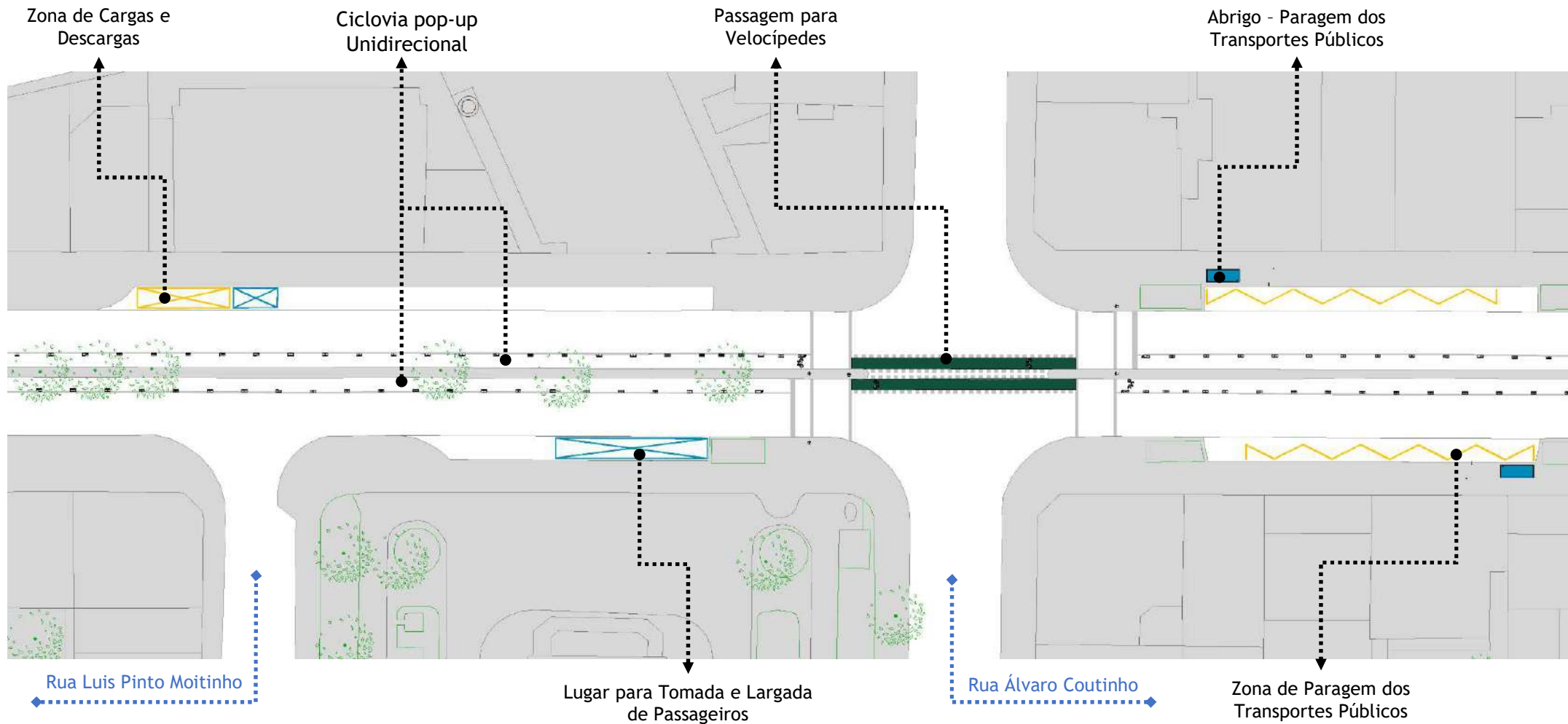

Troço 9

Avenida Almirante Reis

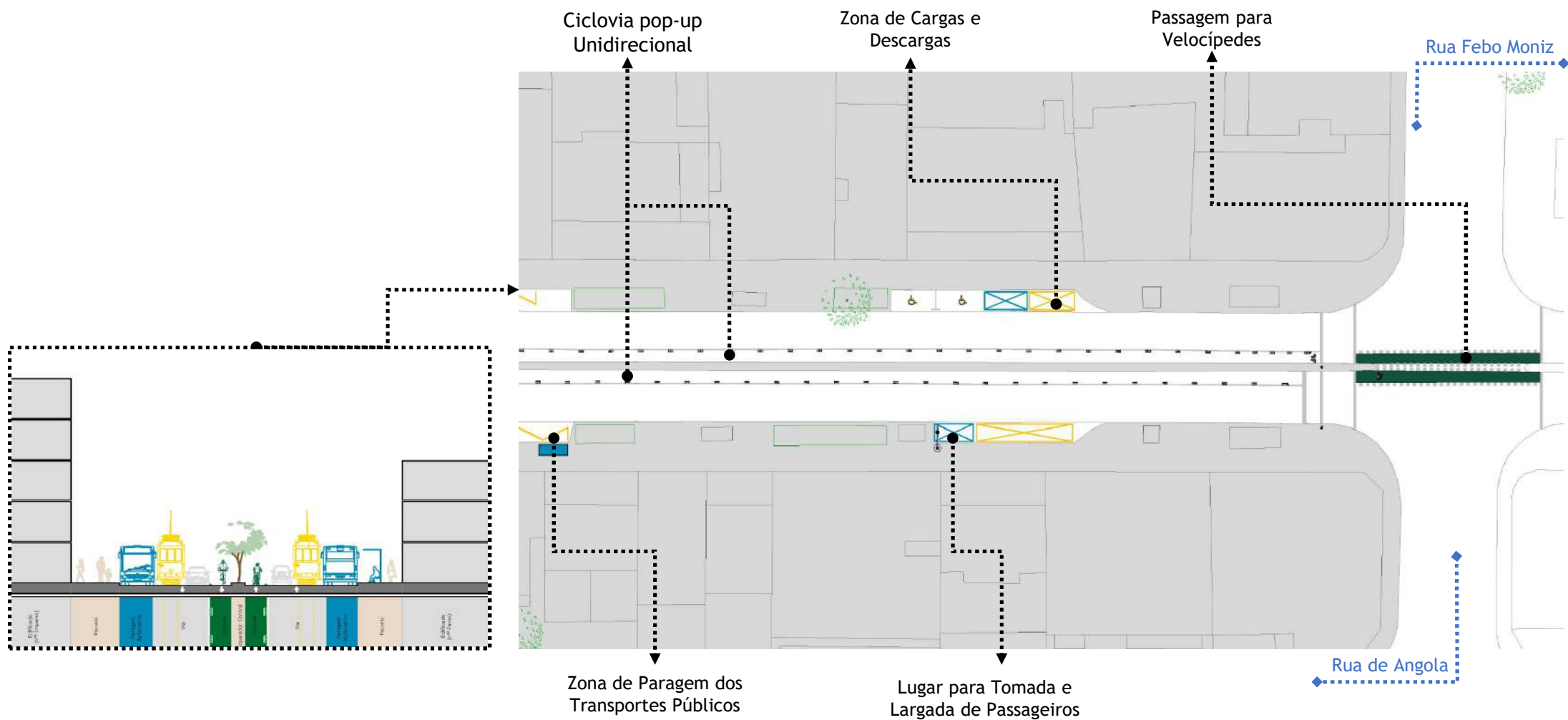

Troço 10

Avenida Almirante Reis

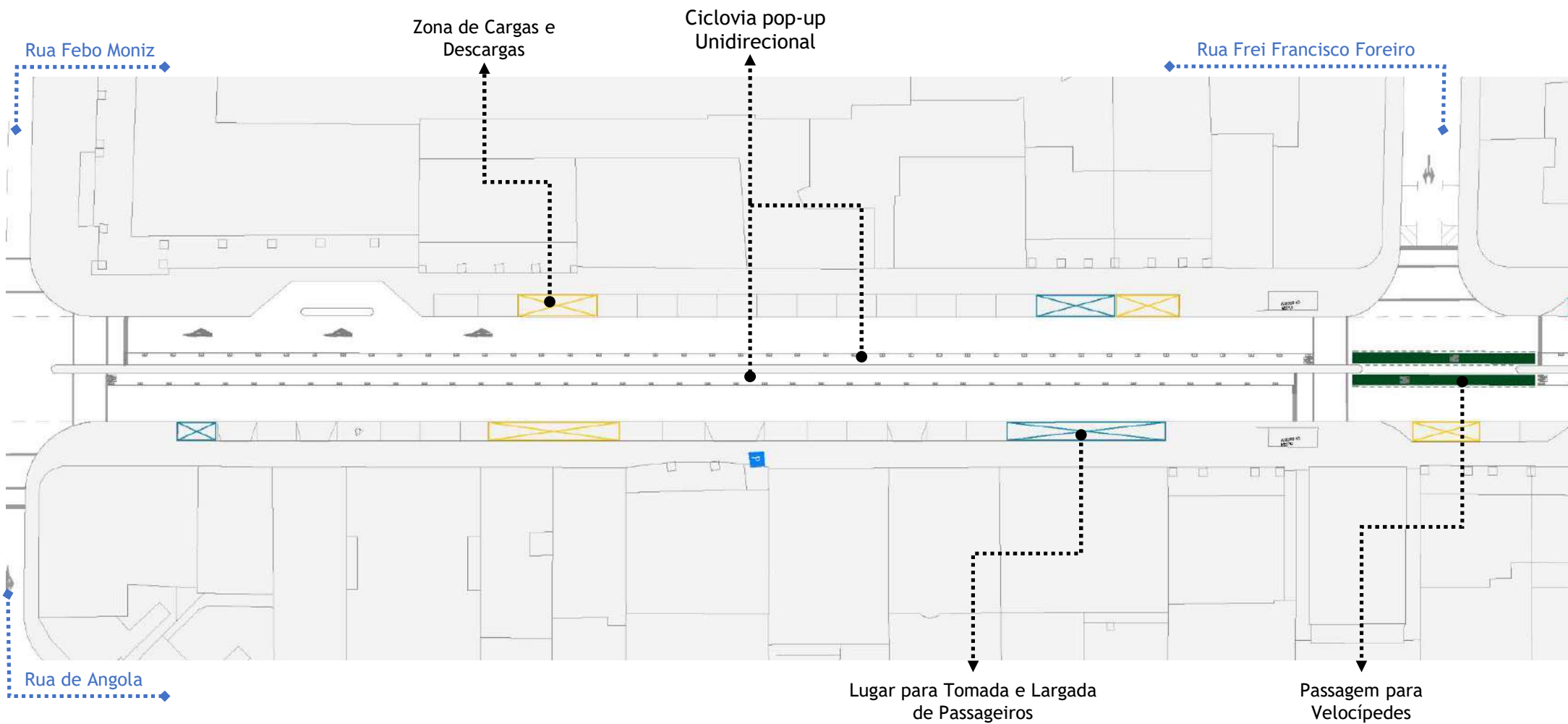

Troço 11

Avenida Almirante Reis

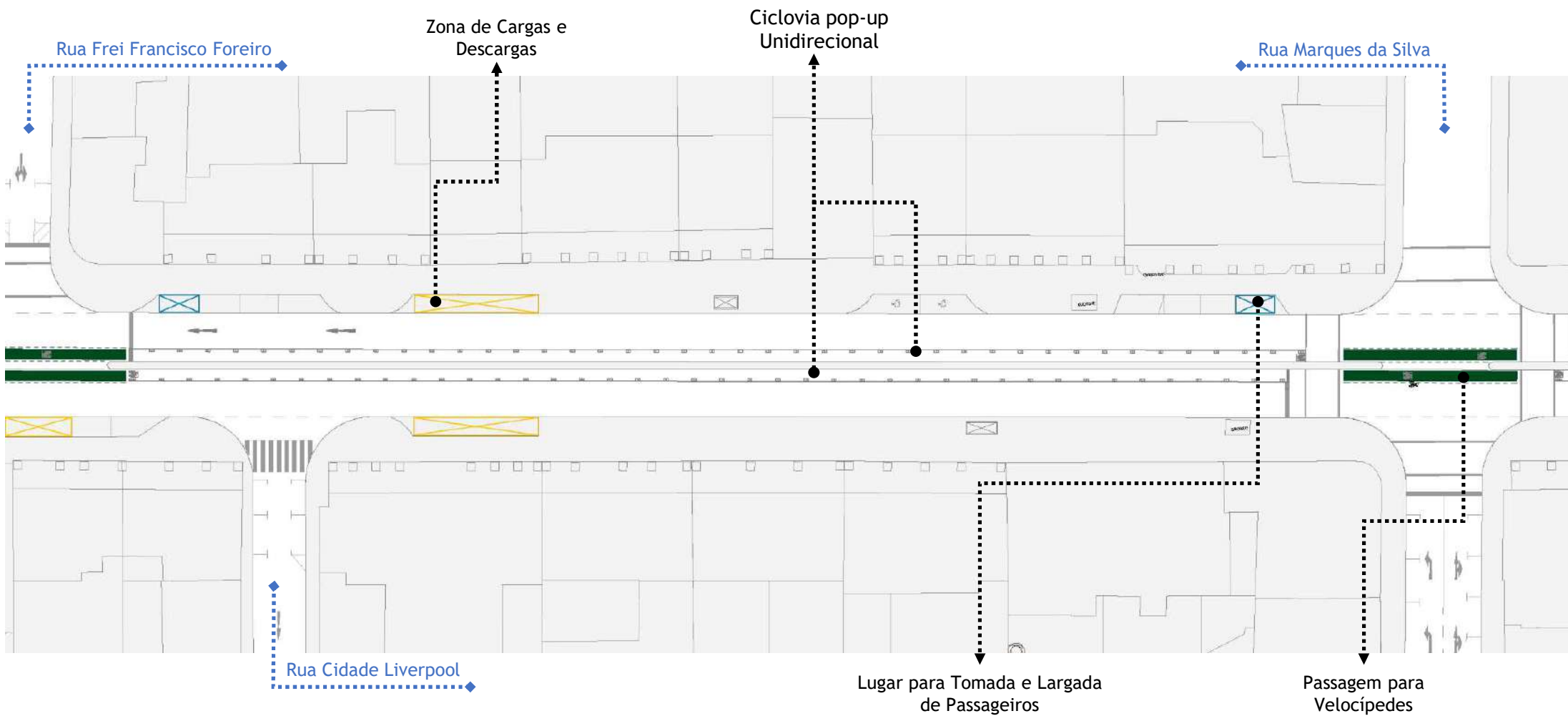

Troço 12

Avenida Almirante Reis

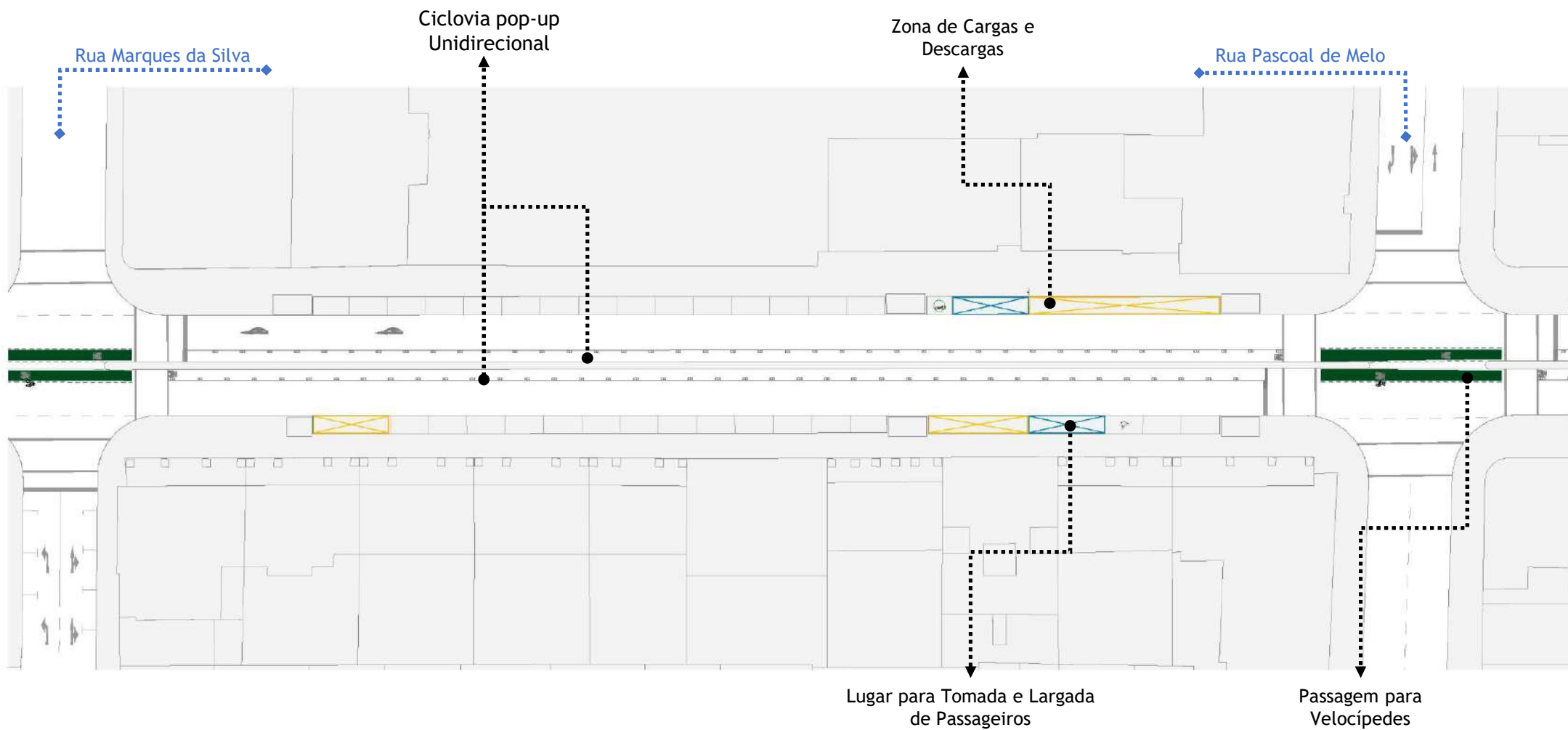

Troço 13

Avenida Almirante Reis

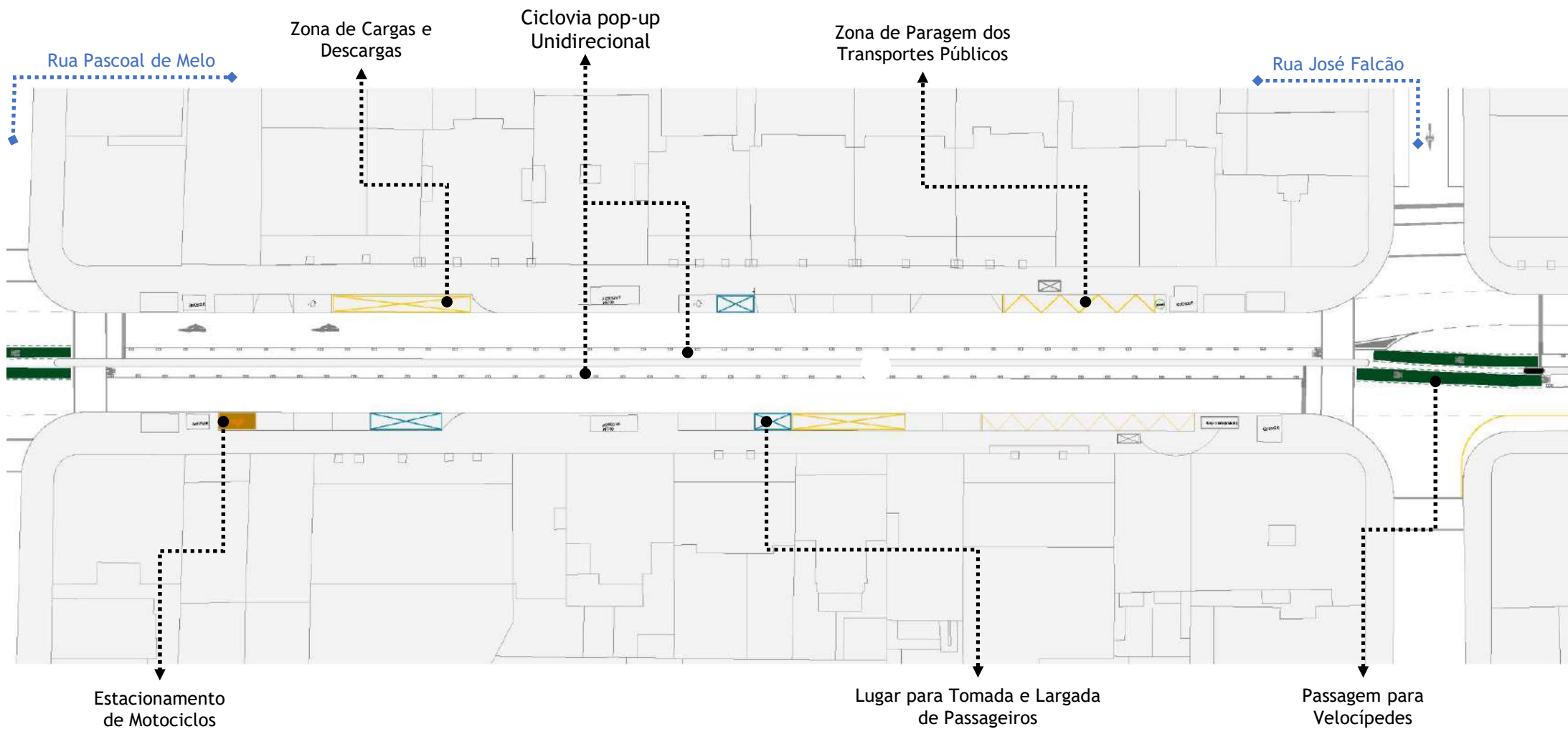

Troço 14

Avenida Almirante Reis

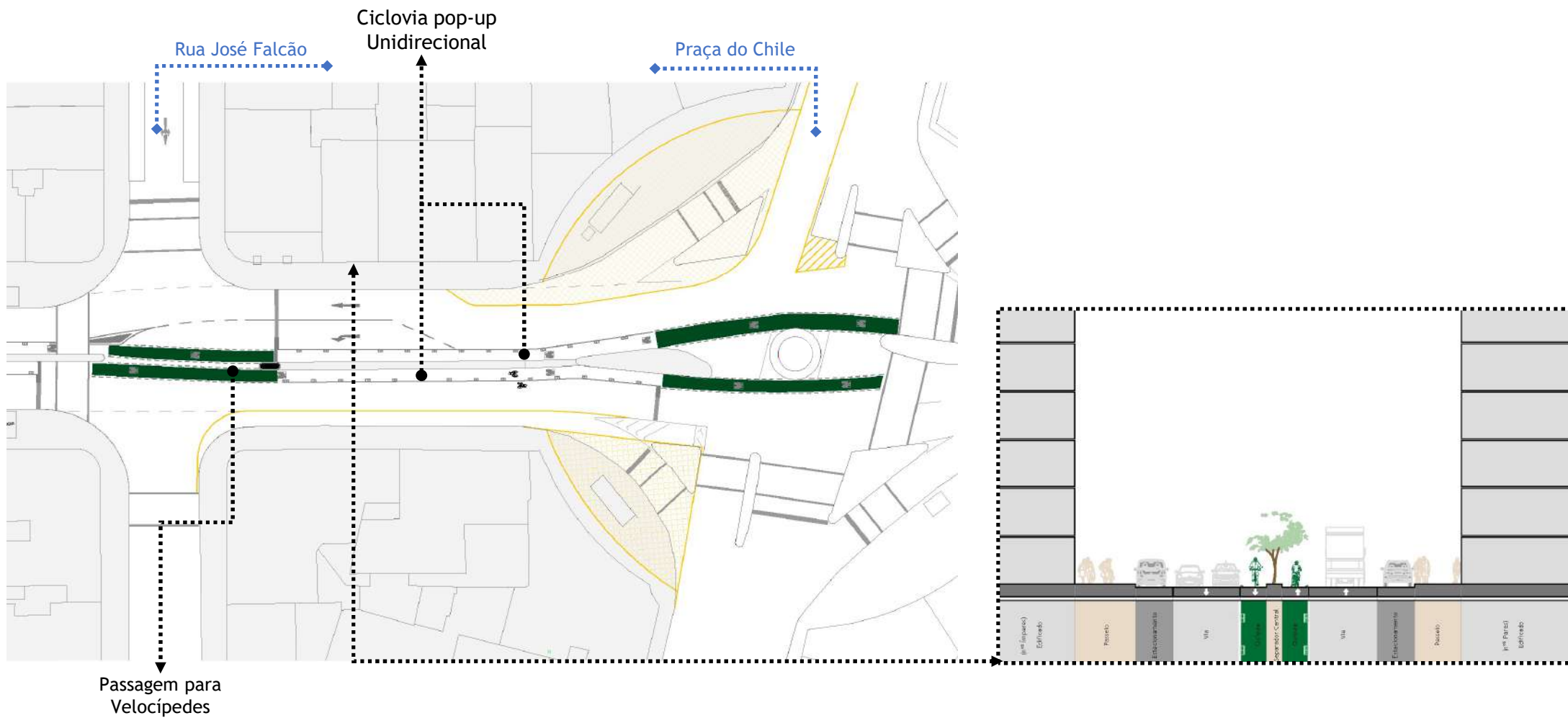

Troço 15

Avenida Almirante Reis

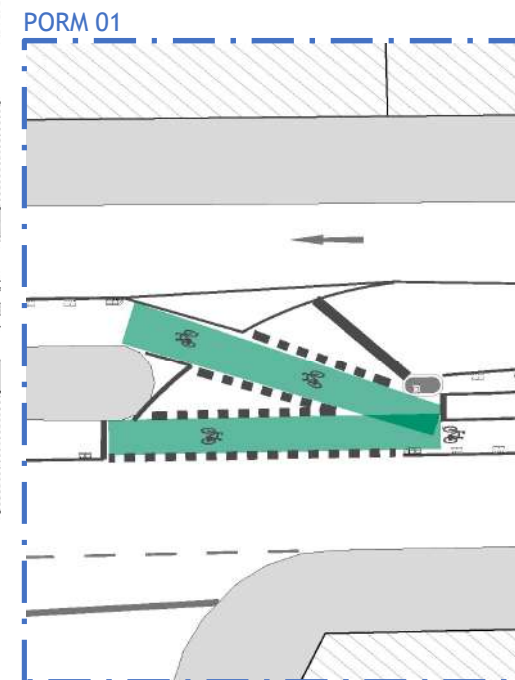
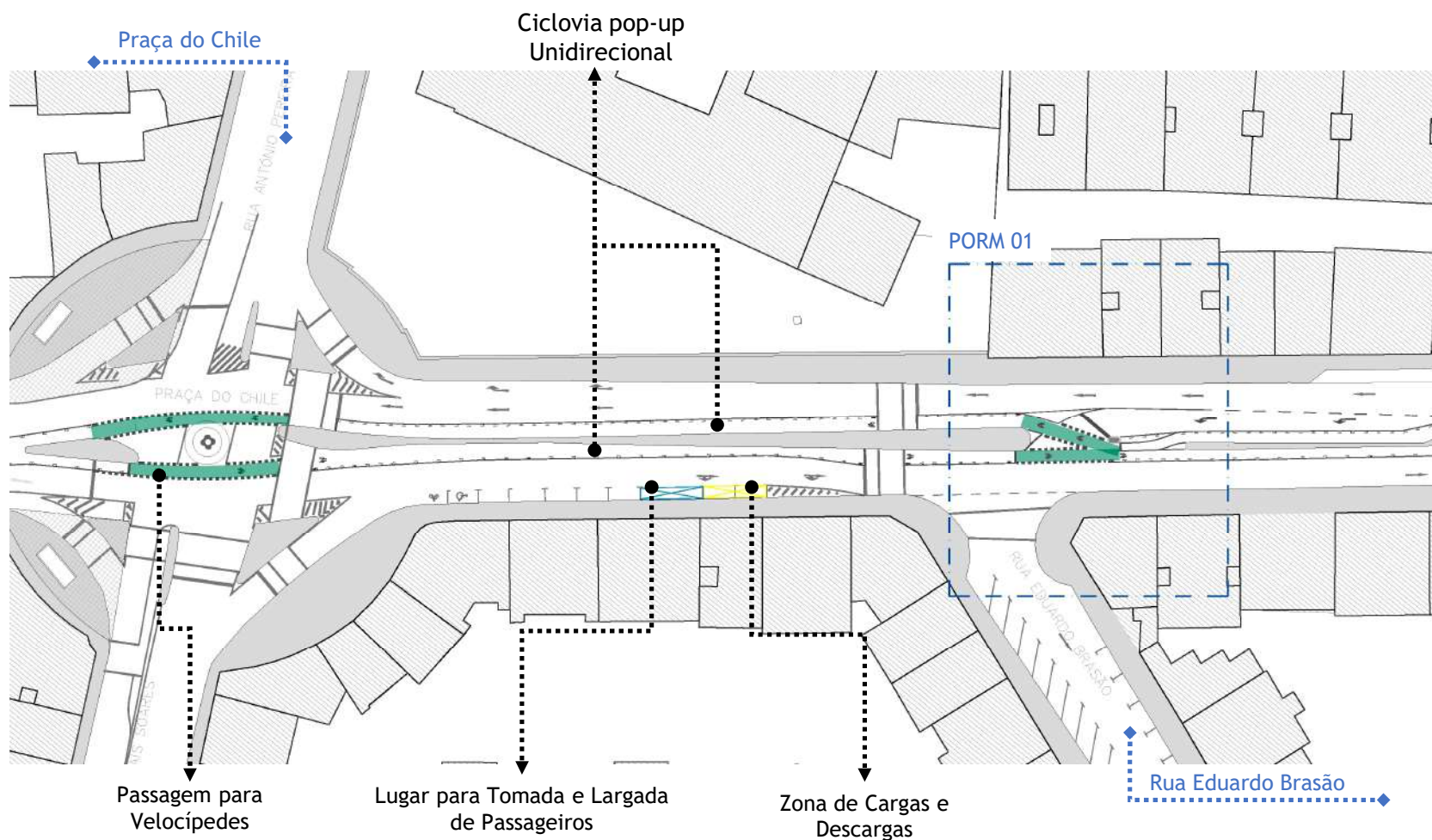

Troço 15

Avenida Almirante Reis - Alameda Dom Afonso Henriques

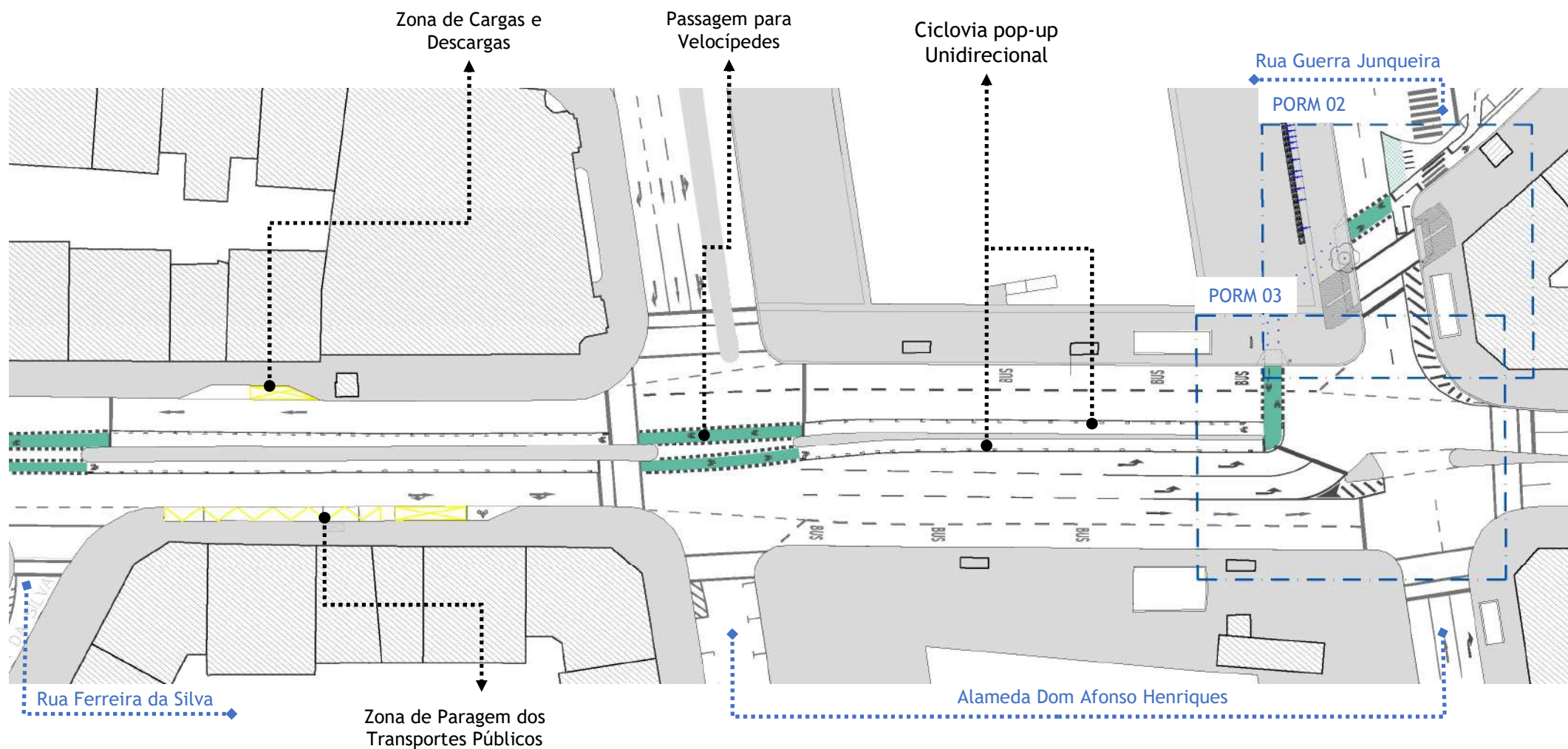

Pormenores

Avenida Almirante Reis - Alameda Dom Afonso Henriques

PORM 02

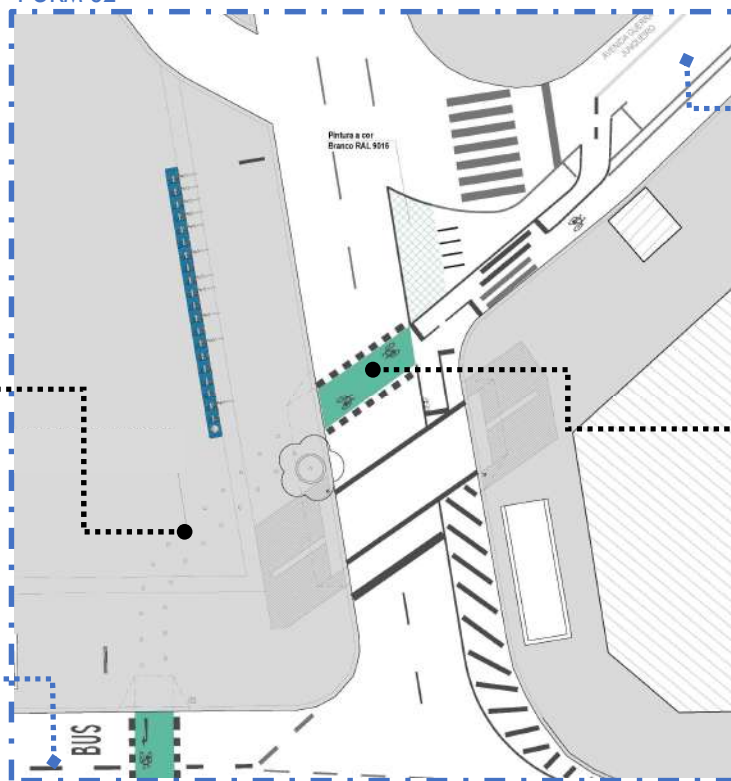

Discos em chapa inox,
com pictograma de
bicicleta

Avenida Almirante Reis

Rua Guerra Junqueira

Passagem para
Velocípedes

PORM 03

